

ACOUSTICAL TREATMENT MANUFACTURERS

- "AEC FABRIC SYSTEM" BY AEC, INC. www.aeccorp.com
- "UPHOLSTERED WALL SYSTEM" BY FABRI-TRAK SYSTEMS, INC. www.fabritrak.com
- "STANDARD WALL SYSTEM" BY WHISPERWALLS CORP. www.whisperwalls.com

LEGEND

- JB 12" X 12" X 4" JUNCTION BOX SURFACE MOUNTED AT 2'-0" AFF. FOR SOUND CONNECTOR PANEL
- PB SURFACE MOUNTED PULL BOX - MINIMUM SIZE REQ'D FOR CONDUIT TRANSITION. (DO NOT BEND AT WALL)
- 110VAC DUPLEX OR QUAD RECEPTACLE SURFACE MTD. ON DEDICATED 20 AMP CIRCUIT FOR TECHNICAL POWER ONLY. (UTILITY OUTLETS NOT SHOWN)
- FB 12" X 18" X 4" JUNCTION BOX RECESSED IN CONCRETE SLAB

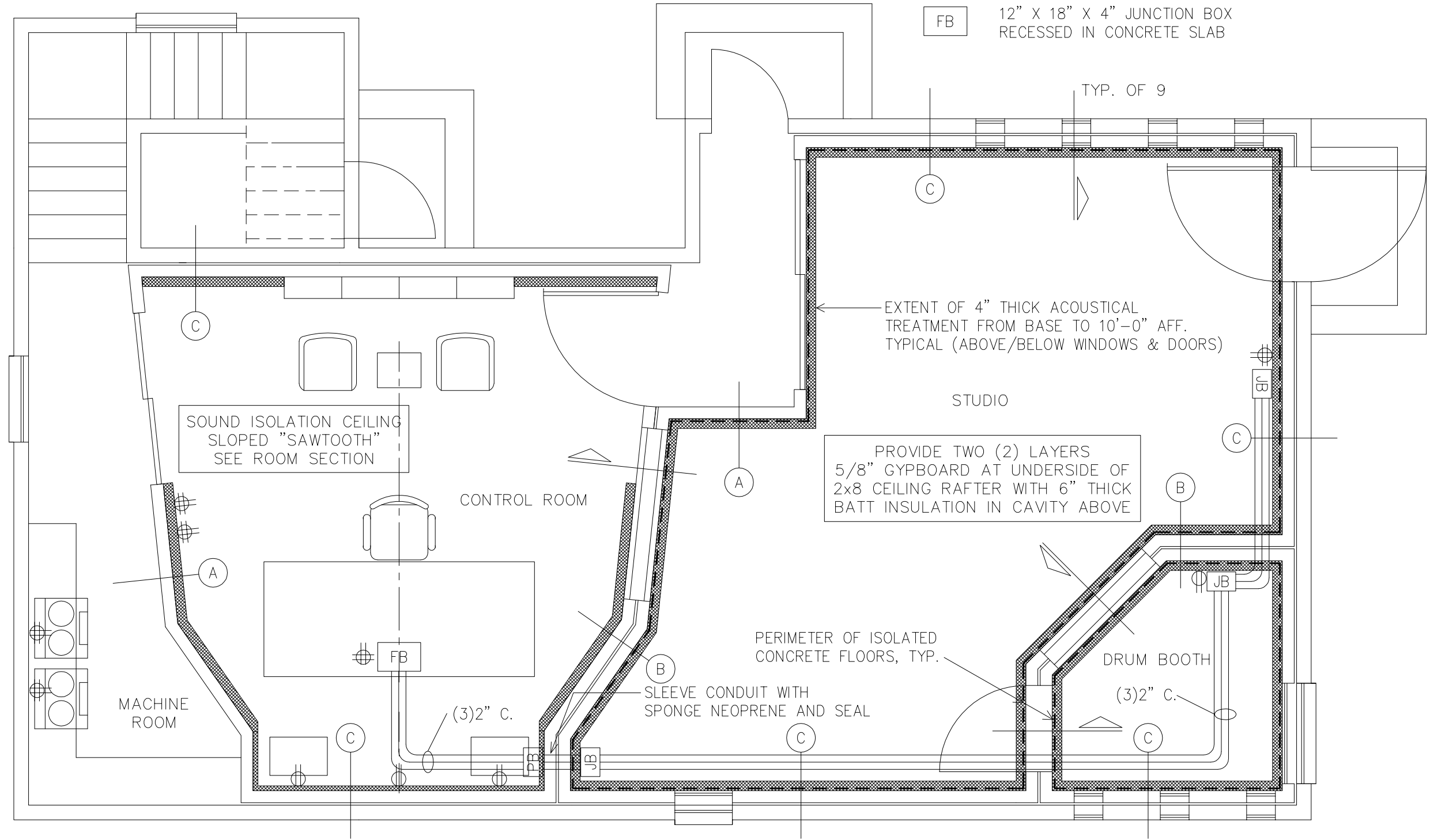

FLOOR PLAN  
SCALE: 1/4" = 1'-0"

ENO RESIDENCE RECORDING STUDIO  
ACOUSTICAL DESIGN DEVELOPMENT  
2201 BOWMAN LANE  
AUSTIN, TEXAS

consultants in acoustics & electronic media system design

**dickensheets**  
DESIGN ASSOCIATES

www.dickensheets.com  
12315 hymeadow drive suite 200 austin, texas 78750 ph 512.331.8977 fax 512.331.8947

PROJECT NUMBER	2132
DATE	06 OCT 2004
DRAWN BY	GRK
CHECKED BY	KRD
SHEET NUMBER:	